

# Square Touch Interface Controller

## LC-000W-D4-01

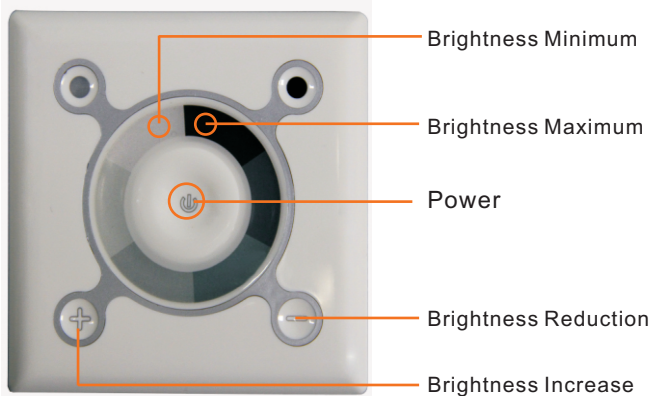

### Features

Used for Monochrome LED strip/luminaires, built-in touch button and touch ring to adjust brightness.

### Technical Parameter

Input voltage: DC 12V / 24V

Output channel: 1 Channel constant-voltage

PWM signal output 8A/channel\*1

Weight:105g

### Dimensions (Unit: mm/inch)

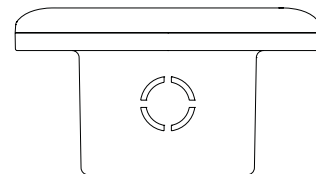
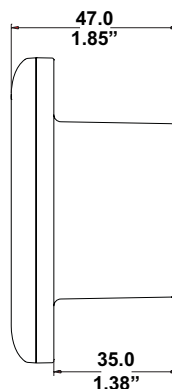
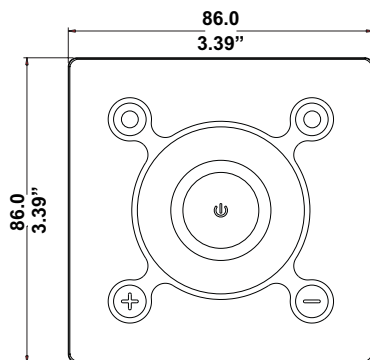

### Function Descriptions

- 1.Touch ring (64 levels) and touch button(256 levels) for brightness adjustment;
- 2.Power-loss memory recovery function;
- 3.Shortcut button for brightness adjustment;
- 4.Long press "+" and "-" for constantly adjusting brightness.

### Button function:

(There is a LED indicator light under each button, which is called background light here)

Function of touch button:

Button ⊖ : Reduce the brightness(Flash once when it be touched every time; Continue flashing when long pressing the button; background light is off means 0% brightness)

Button ⊕ : Increase the brightness(Flash once when it be touched every time; Continue flashing when long pressing the button; background light is off means 100% brightness)

Button ⊙ : Shortcut button for 20% brightness.

Button ⊚ : Shortcut button for 100% brightness.

Button ⊕ : Switch button(Red background light will be on when switch is off, and the light will be off when switch is on).

## Power-loss memory recovery function:

Brightness and switch status both have power-loss memory recovery function.

## Connection Drawing:

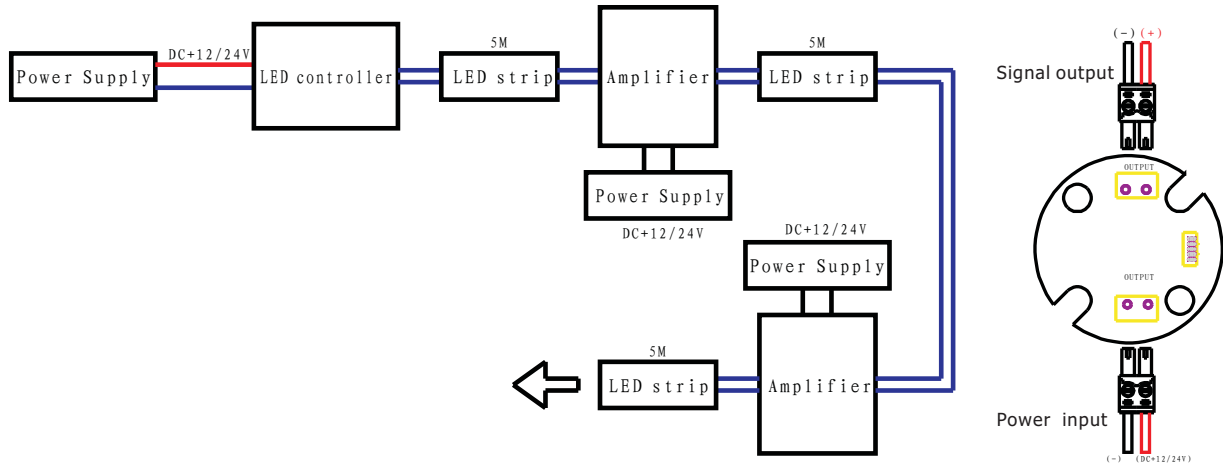

## Installation Drawing:

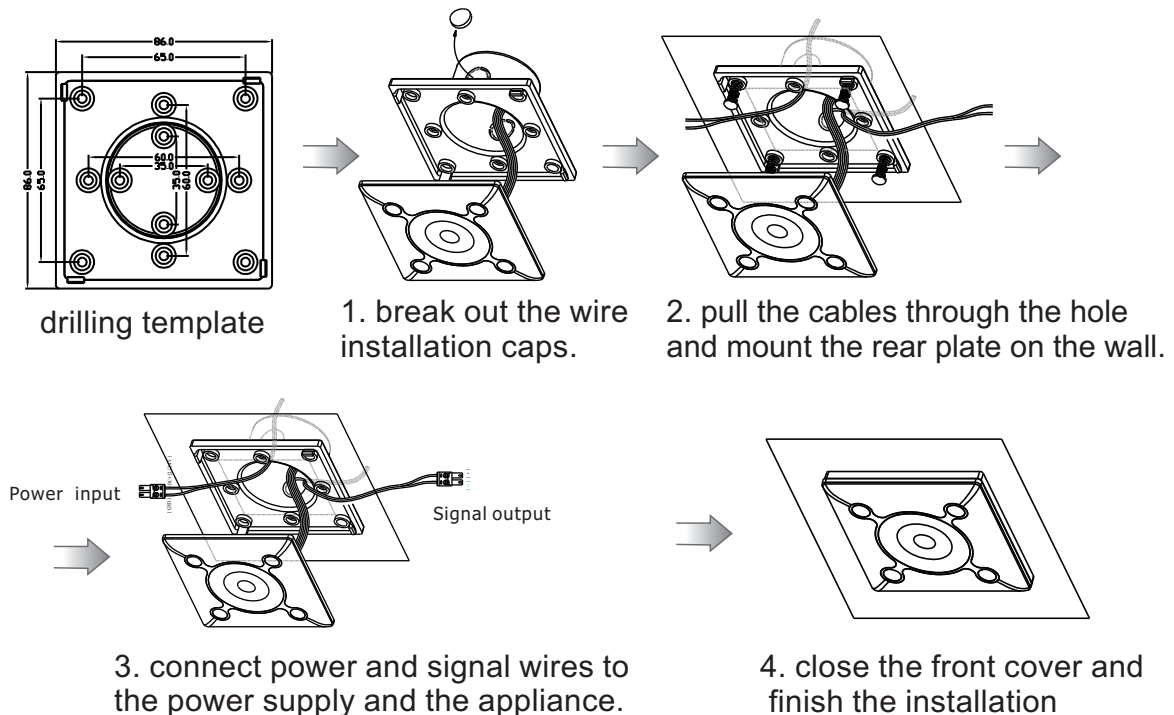

## Cautions:

1. Output of this controller is 1 channel signal, so the connection sequence of the wires must be correct.
2. Use only 12V DC or 24V DC power supply, do NOT use high voltage AC!
3. When installing the controller, first cut off the power of controller, connect well the LED light with controller, then connect the controller with power supply.